

# POLYSCREED GHF TERRAZZO

## Heavy Duty 8 to 10 mm Terrazzo Polyurethane Floor Screed



A high performance three component trowel applied, decorative polyurethane flooring system finished to a smooth polished terrazzo.

It provides a smooth, protective floor finish with exceptional physical and chemical resistance in demanding industrial environments with high traffic volumes. Ideal for applications in the food, pharmaceutical and manufacturing industries. HACCP compliant with antimicrobial silver ion technology ideal for food processing areas.

### UNIQUE PRODUCT BENEFITS

- Decorative, attractive finish. Fully customizable system.
- Lifetime durability.
- High chemical, impact, abrasion and thermal shock resistance.
- Seamless and easy to clean. Antimicrobial silver ion technology.
- HACCP compliant - Ideal for food processing environments.
- Solvent-free, environmentally friendly.

### TECHNICAL DETAILS

Compressive Strength	> 55 MPa	BS6319
Tensile Strength	> 6.5 MPa	
Flexural Strength	> 40 MPa	
Concrete Adhesion	> 1.5 MPa (Concrete failure)	ASTM D7234
Impact Resistance	1 kg > 1.8 m 2 kg > 1.5 m	ISO6272 -1:2011
Hardness	80	Shore D
Slip Resistance	Dry > 40	BS7976-2
Water Uptake (Permeability)	Nil	Karsten Test
Heat Resistance	- 40°C to 105°C @ 9 mm Intermittent up to 120°C	
Chemical Resistance	Acids, alkalis & sugars, oils, hydrocarbons	
Light Traffic	12 to 16 hrs	
Heavy Traffic	24 hrs	
Pot Life	8 to 12 min	
Kit Yield	18 L	
Coverage @ 8 mm	2.2 m <sup>2</sup> / kit	
Coverage @ 10 mm	1.8 m <sup>2</sup> / kit	

### PRODUCT COLOUR RANGE:

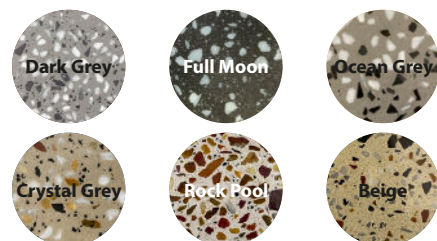

\*Product colours may differ from the ones shown above. For a full colour chart or for samples, contact your nearest Technical Finishes branch. UV exposure yellowing is more prominent in light colours yet does not affect performance.

**Leading manufactures of specialist epoxy and polyurethane flooring systems, specialised construction and corrosion protection products.**

Distribution facilities nationwide

**Western Cape**

+27 (0)21 535 4455

**Eastern Cape**

+27 (0)41 451 3944

**Gauteng**

+27 (0)11 822 7242

**KwaZulu-Natal**

+27 (0)31 705 7733



info@technicalfinishes.com • www.technicalfinishes.com



**TECHNICAL FINISHES**  
SPECIALIST FLOORING AND CONSTRUCTION SOLUTIONS

## APPLICATIONS:

- Commercial and retail flooring
- Offices and receptions
- Factories and breweries
- Hospitals and veterinary
- Kitchens and restaurants
- Museums & automotive
- Bathrooms and ablutions
- Sports facilities and gyms
- Bars, clubs and leisure centres
- Living spaces and schools
- Wet or dry process areas
- Butcheries and bakeries
- Food preparation areas
- Pharmaceutical laboratories
- Salons and hairdressers

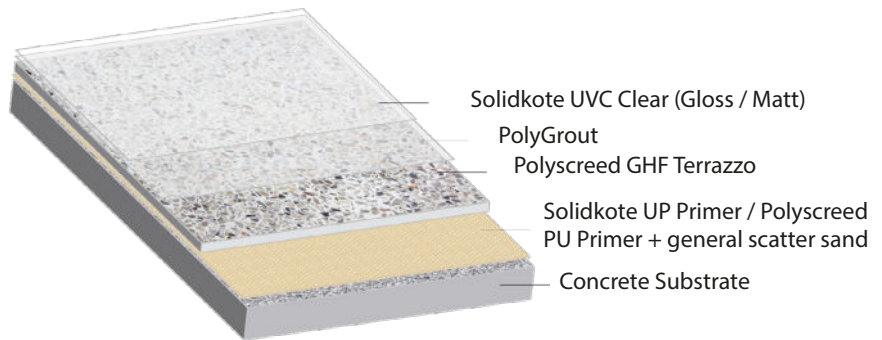

Note: Any filling of blowholes / voids and surface levelling of substrate can be achieved using appropriate products within Technical Finishes Construction Range (please speak to one of our technical sales representatives).

## PREPARATION

Remove all previous coatings, unbonded concrete and laitance mechanically through diamond grinding, abrasive blasting or scarifying to obtain a sound and porous surface (sandpaper texture). Sweep dust and loose debris followed by vacuuming, to obtain a dry and dust-free surface. It is standard practice to ensure grooves 5 mm by 5 mm, run parallel to and 150 mm from all walls, plinths, finished edges, expansion joints, columns.

## PRIMING

Ensure application conditions are between 5 to 25°C and at a maximum of 75% Relative Humidity.

If the substrate moisture content is:

- |                 |   |
|-----------------|---|
| Less than 5%    | Prime with either:<br>Solidkote UP Primer or<br>Polyscreed PU Primer. |
| Greater than 5% | Prime with<br>Polyscreed PU Primer.                                   |

Broadcast 0.7 to 1.1 mm sand into wet primer at 300 g / m<sup>2</sup>. Allow primer to cure for at least 16 hours prior to application of Polyscreed GHF Terrazzo. Allow primer to cure for 48 hours in cold weather.

## COLOUR STABILITY

The colour of the system will fade when subject to direct sunlight and high intensity lighting. The rate of colour change is unpredictable.

## STORAGE

Store in a cool, dry place on pallets off of the ground. Avoid direct sunlight and high humidity. Shelf life is 6 months in original unopened packaging.

## SYSTEM BUILD-UP

- |                   |   |
|-------------------|---|
| 1. Primer         | Polyscreed PU Primer with 300g / m <sup>2</sup> general scatter stone |
| 2. Screed Topping | Polyscreed GHF Terrazzo   |
| 3. Grout          | PolyGrout   |
| 4. Sealing        | Solidkote UVC Clear (Gloss / Matt)                                    |

## SUBSTRATE REQUIREMENTS

Concrete substrates must have a minimum compressive strength of 20 to 25 MPa, a minimum tensile pull-off strength of 1.5 MPa and be free of oil, fat, grease, dust, and loose friable materials. There must be no moisture vapour rising from the concrete and moisture content must be less than 5%.

**Leading manufactures of specialist epoxy and polyurethane flooring systems, specialised construction and corrosion protection products.**

Distribution facilities nationwide

Western Cape  
+27 (0)21 535 4455

Eastern Cape  
+27 (0)41 451 3944

Gauteng  
+27 (0)11 822 7242

KwaZulu-Natal  
+27 (0)31 705 7733



info@technicalfinishes.com • www.technicalfinishes.com



**TECHNICAL FINISHES**  
SPECIALIST FLOORING AND CONSTRUCTION SOLUTIONS

## INSTALLATION:

Ensure application conditions of 5 to 25°C. Ensure adequate lighting to achieve an even and level spread. Installation should not be attempted unless application team is fully trained.

### Mixing

Open aggregate bag (Part 3) before the mixing starts to ensure no time is wasted between mixes / kits. Shake Part 1 and Part 2 vigorously prior to opening.

Set up the mixing machine as close to the floor as possible (Use two mixing vessels to ensure time between mixes / kits is minimized).

Decant Part 1 into mixing vessel, start timer when adding Part 2 and mix for 30 seconds. Once 30 seconds is complete, pour Part 3 into the mix and mix for a further 2 minutes until uniformly wetted out.

### Placing

*Applied at 10 mm, ground to 8 mm.*

Pour out the mix onto the demarcated area (controlled clearance screed box recommended) and pull evenly with a straight edge. Float the screed using plastic trowels to close the surface. In cold weather gently roll the surface of the screed with a mohair roller dipped in Xylene. As soon as the first mix has been placed, the next mix should be delivered to the floor and placed into the previous mix. Lightly roll the surface with a medium pile mohair roller immediately to remove trowel marks and mix join regions (regions where two mixes meet).

Ensure mohair rolling is within 8 minutes of the start time of each mix. Allow the surface to settle and cure for 36 hours before proceeding.

### Grinding and Polishing

Ensure the grinding takes place within 48 hours (While screed strength is approximately 35 MPa). The first grind must be done with 40-grit metal bound diamond bits to expose 95% of the aggregate. Wet the surface with water to reveal the exposed aggregate.

For the second stage grind use 60 / 80-grit metal bound diamond bits. Wash and vacuum the entire floor.

For the third stage grind use 100 / 120-grit metal bound diamond bits.

For the fourth stage grind use 200-grit resin pads.

For the fifth stage grind use 400-grit resin pads.

### Grouting

A damp floor is needed for the grouting phase. Grout the floor to close holes and pits using **PolyGrout**. Allow the grout to cure overnight. Grout a second time if pin holes and pits have to be closed effectively.

### Finishing

Polish excess grout off the surface using 200-grit resin bound diamond pads. Proceed to polish the floor to a minimum of 400-grit diamond. Wash and vacuum dry.

## SEALING

Stain resistance is enhanced if the Polyscreed GHF Terrazzo surface is sealed. Solidkote UVC Clear (gloss / matt) is recommended. Buff the floor before final sealer coat using a white pad on a rotary polishing machine.

## MAINTENANCE

Regular cleaning extends the service life of the Polyscreed GHF Terrazzo system. Maintenance is to be carried out using Liquid Action which complies with SANS 1344 Medium Duty Solvent Detergent (2112/P3325/10/ID).

## ANTIMICROBIAL RESISTANCE

An important advantage of the Polyscreed range is its silver ion technology which inhibits the growth of bacteria and fungi ensuring a more hygienic surface.

**Leading manufactures of specialist epoxy and polyurethane flooring systems, specialised construction and corrosion protection products.**

*Distribution facilities nationwide*

**Western Cape**

+27 (0)21 535 4455

**Eastern Cape**

+27 (0)41 451 3944

**Gauteng**

+27 (0)11 822 7242

**KwaZulu-Natal**

+27 (0)31 705 7733



info@technicalfinishes.com • www.technicalfinishes.com



**TECHNICAL FINISHES**  
SPECIALIST FLOORING AND CONSTRUCTION SOLUTIONS

## HEALTH AND SAFETY

Please read Safety Data Sheet and specific health and safety data for this product provided in compliance with the requirements of OHSA No.85 of 1993. The finished system is not hazardous to health or the environment.

## WARRANTY

Technical Finishes products are manufactured under high quality standards and are warranted against defective materials and are sold subject to standard Terms and Conditions of Sale, copies of which can be obtained upon request. Technical Finishes deals with approved applicators and carry a back to back warranty with these clients. Technical Finishes cannot be held responsible for the workmanship in surface preparation and application of our products, it is understood that the approved contractor will guarantee such workmanship and application. It is vital that the application is done in accordance to our specification.

***Leading manufactures of specialist epoxy and polyurethane flooring systems,  
specialised construction and corrosion protection products.***

*Distribution facilities nationwide*

**Western Cape**

+27 (0)21 535 4455

**Eastern Cape**

+27 (0)41 451 3944

**Gauteng**

+27 (0)11 822 7242

**KwaZulu-Natal**

+27 (0)31 705 7733



**TECHNICAL FINISHES**  
SPECIALIST FLOORING AND CONSTRUCTION SOLUTIONS



info@technicalfinishes.com • www.technicalfinishes.com

## JOINT DETAIL

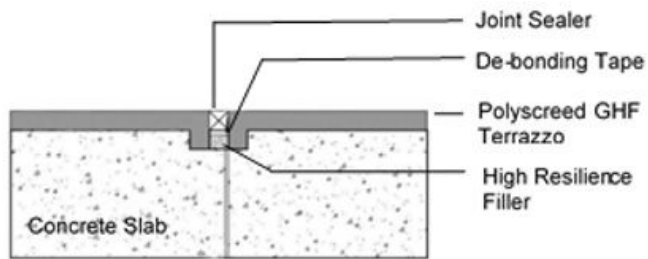

Low Movement Joint Detail

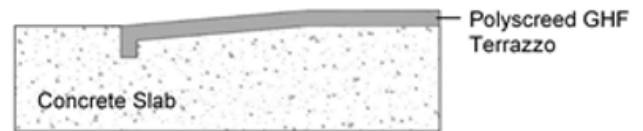

Termination Detail

## COVING DETAIL

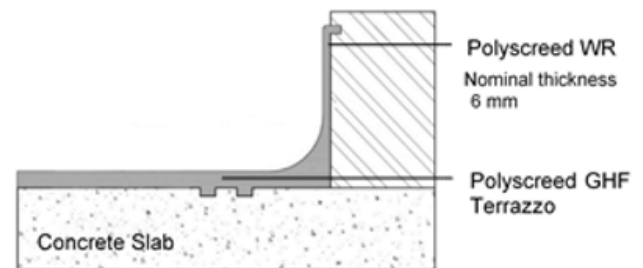
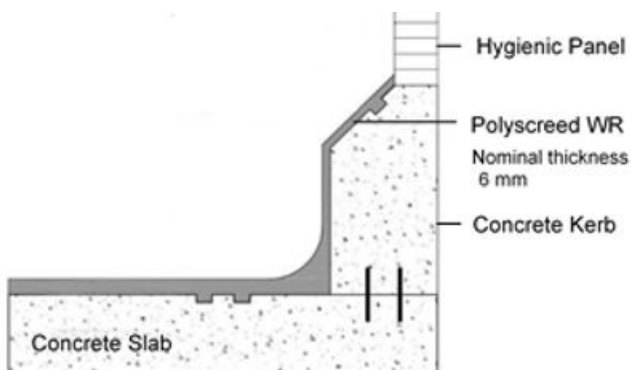

## CHANNEL LININGS

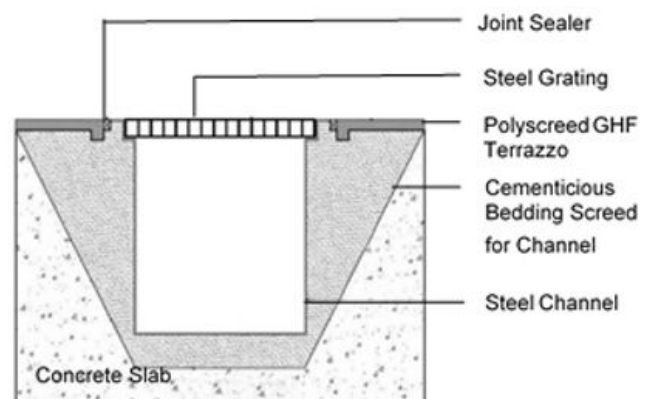
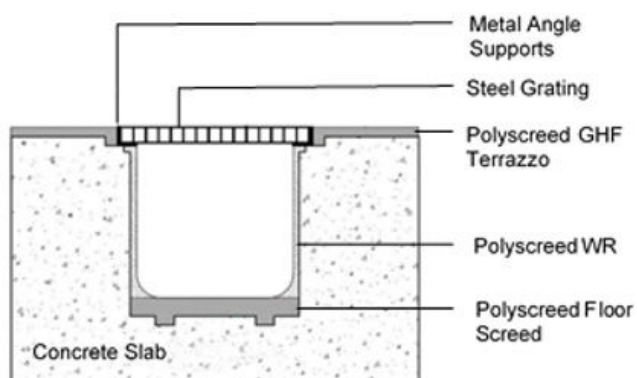

**Leading manufactures of specialist epoxy and polyurethane flooring systems,  
specialised construction and corrosion protection products.**

Distribution facilities nationwide

Western Cape

+27 (0)21 535 4455

Eastern Cape

+27 (0)41 451 3944

Gauteng

+27 (0)11 822 7242

KwaZulu-Natal

+27 (0)31 705 7733



info@technicalfinishes.com • www.technicalfinishes.com



**TECHNICAL FINISHES**  
SPECIALIST FLOORING AND CONSTRUCTION SOLUTIONS